



alpine-property

Alpine Property SAS au capital de 3 450 € - RCS Thonon les Bains 508 578 556 - siège: 153 chemin du Chargeau, 74110 Morzine, France - Titulaire de la Carte Professionnelle n° CPI 7401 2016 000 017 391 délivrée par la CCI de la Haute Savoie

Tel: +44 (0)208 123 2384

Email: info@alpine-property.com

Web: www.alpine-property.com

Chalet La Fleur des Alpes

Le Biot, St Jean d'Aulps & Vallée, Portes Du Soleil

855 000 €uros



Contact

Contact **Ailsa Bishop** about this property.

Tel: +33 6 71 14 68 08

Email: ailsa@alpine-property.com

Key Features

Price	855 000 Euros
Status	FOR SALE
Last updated	22/04/2024
Area	Portes Du Soleil
Location	St Jean d'Aulps & Vallée
Village	Le Biot
Bedrooms	4
Bathrooms	2
Floor area	159 m²
Land area	772 m²
Detached	Yes
Heating	Underfloor heating
Chimney	Wood burning stove
Ski access	Ski bus
Nearest skiing	6.9 km
Nearest shops	4.6 km
Garden	Yes
Garage	Covered parking
Drainage	Mains drains
Taxe foncière	1046.00 Euros
Energy efficiency rating	E (284)
CO2 emissions	B (9)
Agency fees	Paid by the seller

Property Description

Discover this magnificent 159m² chalet on three floors, in the charming village of Le Biot. It is close to the centre and enjoys a splendid view of the mountains and is south-facing, ideal for enjoying the sun throughout the day.

The chalet is on 3 floors and is composed as follows:

On the ground floor, an entrance leading to a toilet and access to the basement, as well as a beautiful room that includes a living room with a wood stove, a dining room, and a fully equipped kitchen.

On the second floor, there are 4 bedrooms, all with balcony access, one with its own shower room and toilet, a bathroom, and a toilet.

In the basement, there is a laundry area and a cellar.

Outside, there is a carport and a perfectly maintained garden that surrounds the house.

Charming and sought-after village in the Aulps Valley due to its good exposure and proximity to ski resorts, Le Biot is located between Thonon les Bains and Morzine, specifically between La Baume and St Jean d'Aulps. The heart of the hamlet offers a bar/restaurant, a bakery, a cheese shop, a hairdresser, and a primary school. Other shops are in St Jean d'Aulps, just a 3-minute drive away. In winter, the nearest ski slopes are those of St Jean d'Aulps (Roc d'Enfer) a few minutes' drive away, or those of the Morzine-Les Gets-Avoriaz area accessible from Morzine. These resorts are part of the vast ski area of Portes du Soleil (650km of slopes), which also extends into Switzerland. In summer, the village offers various hiking possibilities.





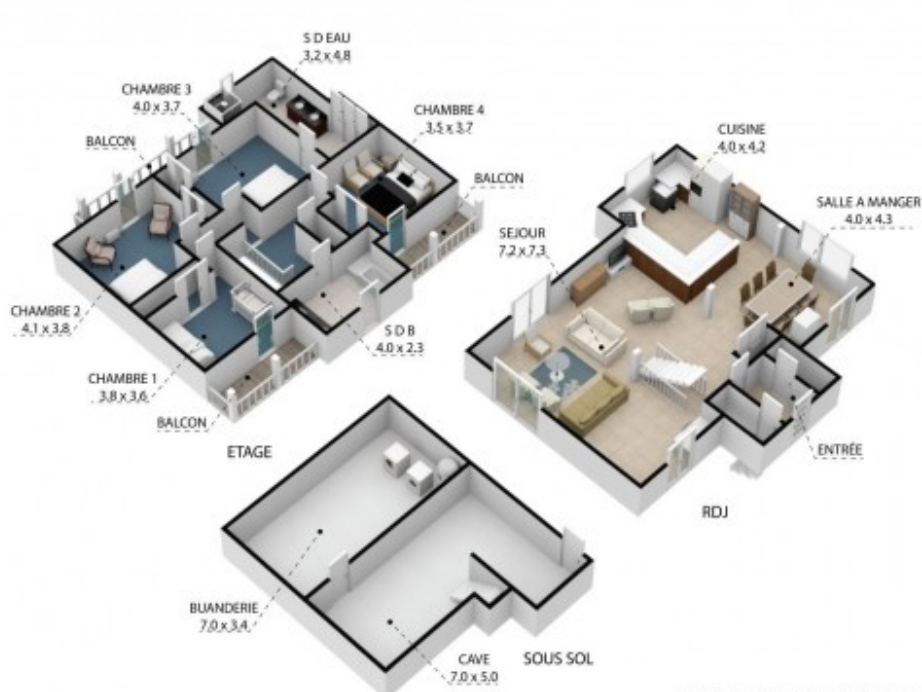

Toutes les dimensions indiquées sont approximatives.
The plans shown are approximate and for information purposes only.

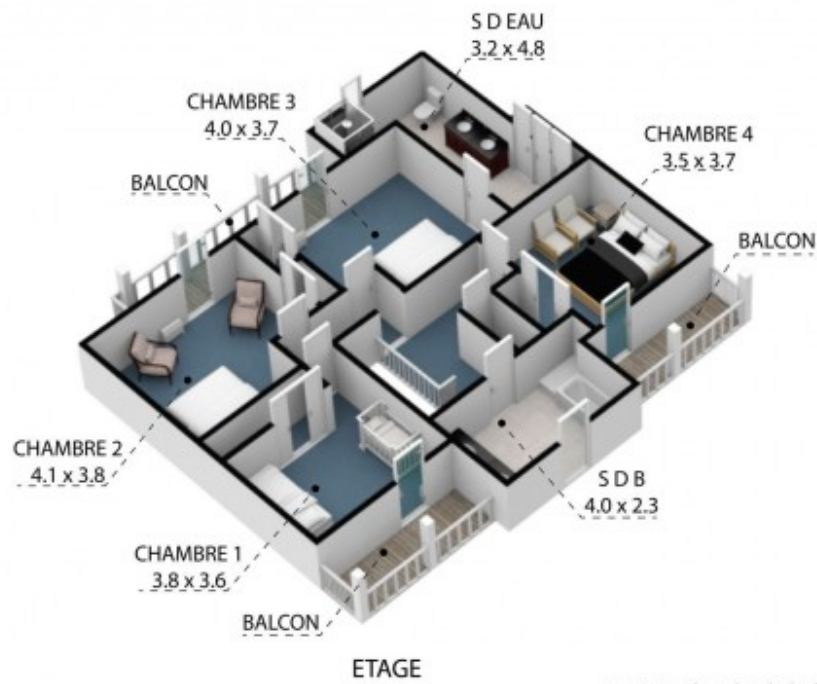

Toutes les dimensions indiquées sont approximatives.
The plans shown are approximate and for information purposes only.



Toutes les dimensions indiquées sont approximatives.
The plans shown are approximate and for information purposes only.

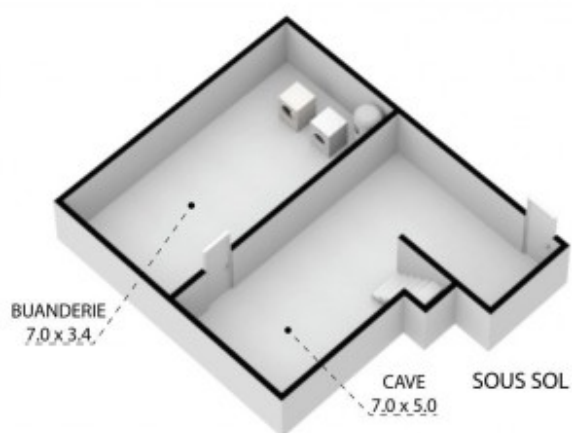

Toutes les dimensions indiquées sont approximatives.
The plans shown are approximate and for information purposes only.

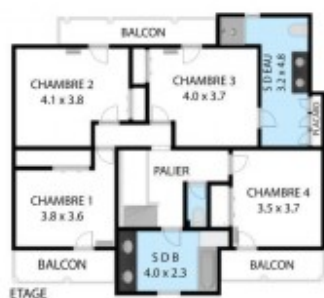

Toutes les dimensions indiquées sont approximatives.
The plans shown are approximate and for information purposes only.



